

Hall Effect Shaft Speed Sensor Installation

The Hall Effect speed sensor can pick up a shaft speed signal from any rotating ferrous metal projection, such as sprocket teeth on the enclosed 60-slot laser cut disc.

The gap between the sensor face and the metal projection must be **no more than 2 mm**.

Install as shown in the diagram below with the two sensor clamps supplied. Depending on the geometry of the teeth, you may be able to sense off the face of the gear with the teeth passing past the centre of the sensor.

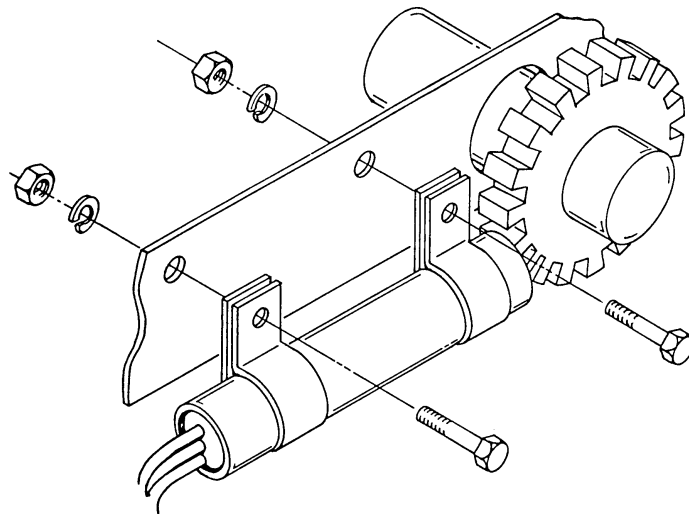

Refer to the Operators' Manual of the DICKEY-john product you purchased to determine how to calibrate your speed sensor.